

\$149,900 - Lot 22 Cooper Road, Windermere

MLS® #10330791

\$149,900

0 Bedroom, 0.00 Bathroom,
Vacant Land on 0.29 Acres

Windermere, Windermere, British Columbia

Welcome to Lot 22 in the desirable COPPER POINT ESTATES - A stunning development surrounded by the Copper Point Ridge Golf Course! This lot is 0.29 acres and boasts beautiful mountain views. Now is your chance to start planning to build your dream home! No building timelines and NO GST. Located only a short drive to downtown Invermere, Panorama and Fairmont Ski Resort, Lake Windermere and all that the Columbia Valley has to offer! (id:36535)

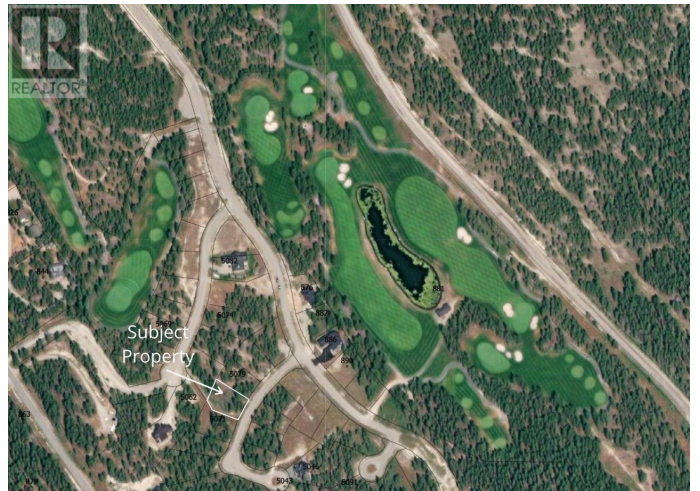

Essential Information

Listing #	10330791
Price	\$149,900
Bathrooms	0.00
Acres	0.29
Type	Vacant Land
Sub-Type	Strata

Community Information

Address	Lot 22 Cooper Road
Subdivision	Windermere
City	Windermere
State	British Columbia
Zip Code	V0B2L0

Amenities

Amenities	Golf Nearby, Shopping, Ski area
Utilities	Cable, Electricity, Telephone, Sewer, Water

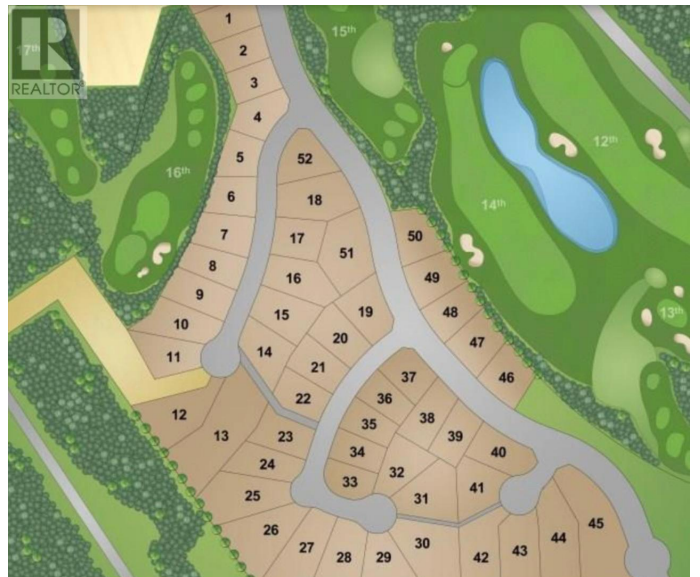

Features	Treed
View	Mountain view, View (panoramic)

Exterior

Exterior Features	Landscaped
-------------------	------------

Additional Information

Zoning	Unknown
--------	---------

Listing Details

Listing Office	Courtesy Of Jenna Minnaar Of RE/MAX Invermere
----------------	---

MLS®, REALTOR®, and the associated logos are trademarks of The Canadian Real Estate Association.